



+975-2-321506/321507

[www.bicma.gov.bt](http://www.bicma.gov.bt)

[bicma@bicma.bt](mailto:bicma@bicma.bt)

## Digitization of Cable Television Systems and Services in Bhutan Advocacy



## Digital Cable Television

Digital cable is a type of cable television that uses digital signals instead of analog. Because it uses digital signals it has many advantages over the older analog cable television.

### Current Status

- Currently, the Cable TV services provided by most of the cable television operators are analogue in nature in Bhutan.
- The Dzongkhags such as Thimphu and Phuntsholing have digital cable TV services.
- Other Dzongkhags are in the process of converting analogue to digital cable television services.

## Difference

The analogue cable television signal comes from a coaxial cable and it is connected directly to the back of the TV set through balun. The channels are controlled by only one remote control device.



The digital cable television system requires an additional device such as HDMI cable, set top box, and remote-control device for set top box.



## Benefits

- Better quality sound and pictures.
- Subscriber can easily inform operator of immediate temporary disconnection and easy reconnection.
- Proper complaint redressal system.
- Browse channels through electronic program guide (EGP).
- Provides subscribers with convenience in subscription payment.
- Transparency in subscriber management systems and records.
- Revenue to the government.
- Provides uniform TV channels nationwide.
- Value added services including internet, pay-per-view features.

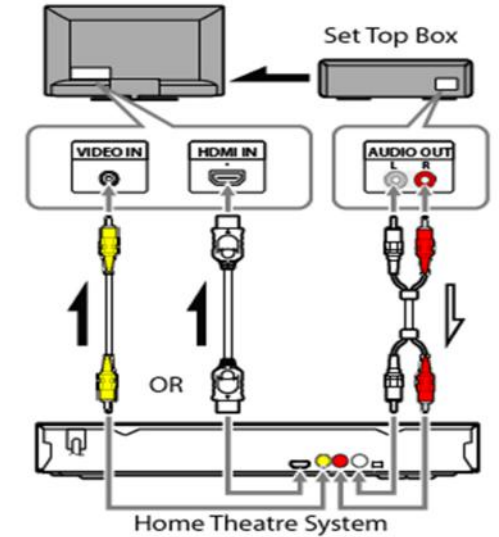

## Technical Set up

Need to connect coaxial cable to the set top box and the HDMI cable from set top box to the back of your TV set. After that use the remote control for set top box to configure the television channels instead of TV set remote. Then put your TV into digital mode by choosing the HDMI as source input.

The digital cable TV signals are distributed by the Multi Service Operators (MSOs) in the country.

To avail Digital CaTV kindly contact your respective cable operators